



Part of the RSK Group of companies

Issue 39 2024

GLOBAL NEWS



In This Edition.....

- * Project News
- * New Starters
- * Celebrations
- * A Day In The Life...



globalnews@grcl.co.uk

Foreword

Welcome to another edition of the Global News Magazine.

As the Global business is becoming more integrated with RSK, in both the UK and Ireland, we are starting to see emerging opportunities for both companies within the overall group. This should benefit both the UK and Ireland in the years ahead.



On the project news front, our UK colleagues in GRCL have successfully concluded the Feltham Resignalling Phase 5 for AtkinsRealis. A very well done to all. While at the Feltham ASC ongoing work to declutter the Relay Room is providing Network Rail with much needed storage capacity. At the BAM UK & Ireland site at Agar Grove Bridge, London the GRCL E&P team made further inroads to eliminating all E&P assets before the bridge is demolished during Christmas 2024.

Collaborating with our sister company, RSK Geosciences, has resulted in successfully completing a new duct route in Rickmansworth for TfL (Transport for London). Also, our contract with CRSA (Central Rail Systems Alliance) realised the completion of copers and surfacing works on platform 4 at Luton Railway Station.

Congratulations to Al Jaber (GRCL Accountant) for achieving the status of Chartered Accountant (ACCA); a fantastic personal milestone.

Also, a special mention goes to Emma Russell Commercial Manager GRCL, for becoming a mentor for Women in Rail, a not-for-profit organisation. Thank you very much Emma. With all the charities we support, we would like to specifically mention Herts Young Homeless and the highly successful charity Golf Day and Richard Horsted (GRCL Design Manager) running the London ½ marathon for raising much needed funds.

In Ireland, Global Rail Services completed extensive electrical and civils works at the picturesque Killarney station. A big shout out to the MEP and Civils teams in ensuring minimal downtime for our client, Iarnród Éireann (Irish Rail).

The Irish telecoms department, GRA Networks, continue their Lightning Protection design and build program for the lighthouses of Ireland. Access via boat or helicopter ensures the Kish lighthouse will be a challenging task later in the year. Staying with the telecom department, all of the Global Rail family would like to wish Tommy Costello (GRSL Storeman) the very best in the next chapter of his journey. Many thanks for the memories.

We have the enviable privilege of thanking our 10 staff in both the UK and Ireland in celebrating their 10-year Awards. A most sincere thank you guys, you are the bedrock of our business. Finally, we welcome our new starters at GRCL; Nisad and Phillip and at GRSL; Mel and Anita.

Welcome on board, we're so glad to have you as part of our team.

On behalf of the management team in the UK and Ireland I would like to thank you for all your commitment and dedication we truly appreciate your effort each day.

Stephen O'Brien
Managing Director
Global Rail Services (Ireland)



We have reached over 5,000 followers on LinkedIn!
Many thanks to our connections and those who follow, like, share and comment on our news, project updates and social content.
We appreciate your support and look forward to engaging with you in the future.



Passionate

Committed in heart and mind to whole-heartedly embrace our core values and culture, without exception.



People

Growing our organisation from within, promoting and empowering our people, inspiring them to be the best they can be.



Professional

At all times we act with integrity, providing quality service, reliably and responsibly.



Teamwork

Working collaboratively whilst supporting and respecting each other's views.



Responsible

To consistently deliver quality, on time, safely and to budget whilst protecting our communities and the environment.





Our **Global Rail Construction Limited** (GRCL) team has concluded the recovery of all redundant assets and made final road traffic light adjustments at Wokingham Level Crossing. This marks the successful conclusion of Feltham Resignalling Phase 5, which has been ongoing since November 2022.

We would like to give a big thank you to GRCL Team Members **Barry Smith, Sam Cheeseman, Scott Spencer, Yassar Khan, Chris Hick, Kriston Abbott, Billy Beechey and Nikhil Shrotri**

our whole team and our Supply Chain Partners for their support and assistance over the past 18 months.

The consistent safe delivery of the works, week after week, has ensured that the final commissioning was successfully completed without any unplanned impact to the operational railway.

GRCL is proud of its involvement in this entire resignalling scheme.



Our vision is that everyone arrives for work healthy and leaves for home safely, everyday.



Global Rail Construction Limited's (GRCL) Signalling & Telecomms team was engaged by client **AtkinsRéalis** in the safe retrieval of usable spare parts and general decluttering of the Relay Room at Feltham ASC, to provide Network Rail with supplementary storage and maintenance Capabilities. This initiative follows the triumphant delivery of the Feltham to Wokingham Resignalling Scheme earlier this year - with our GRCL team playing an important part in its success over several years.





Our **Global Rail Construction** (GRCL) Cambridge Resignalling Project team have been busy!

The photos below showcase one of the essential PSP sites, which our team has completed on behalf of its key client, **Alstom**.

A big thank you to the entire GRCL team at Cambridge for their exceptional quality of workmanship.





During a possession and isolation at Agar Grove, London, our UK E&P team, on behalf of **BAM UK & Ireland**, effectively and securely transferred the existing Lighting Control Panel (LPC), and Three Bridges Comms switching circuit, to a new Lighting Control Cubicle (LCC). The project also included the renewal of two sub-mains to provide power to the existing Moorgate Line tunnel lighting distribution boards. This achievement is a significant milestone for **BAM UK & Ireland** towards eliminating all E&P assets on Agar Grove Bridge, which is due to be demolished during Christmas 2024.



Global Rail Construction Limited (GRCL) part of the RSK Group of companies has completed the modification of 72 No A100 Platform Copers on Platform 4 at Luton Railway Station, Bedfordshire for Central Rail Systems Alliance (CRSA). These adjustments were delivered within specific engineering timeframes.

In light of restricted access, a temporary bridge was set up using a Youngman board system to connect two platforms seamlessly.

Following the completion of coper adjustments and installation of tactiles, 50 metres of resurfacing work was conducted to regulate the platform.

GRCL were also appointed as the Principal Contractor to install a new duct route at Rickmansworth SER on behalf of TfL (Transport For London). Our scope of work encompassed de-vegetation and conducting a Ground Penetrating Radar Survey in collaboration with our sister company RSK Geosciences. Additionally, we were responsible for designing the temporary works to shore up the excavations in preparation for UKPN cable jointing activities.

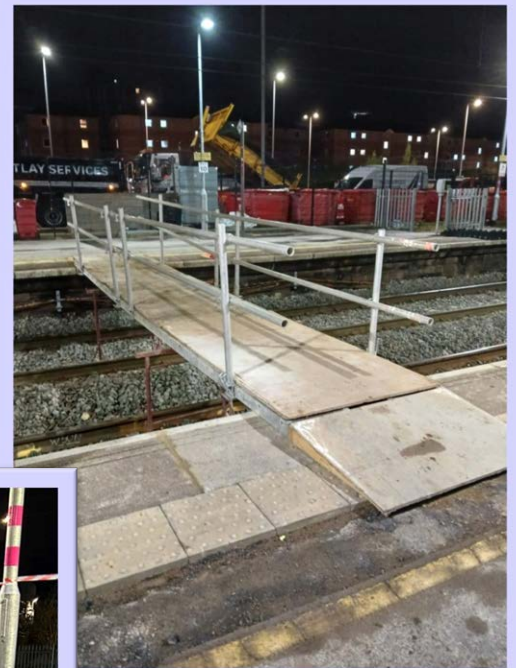

Well done!

Al Jaber, GRCL Accountant, was thrilled to share the wonderful news of his recent achievement: he is now a proud member of the prestigious Association of Chartered Certified Accountants (ACCA).

The journey towards his ACCA qualification has been one of dedication, perseverance, and continuous learning. He committed himself to rigorous study and practical application, which ultimately led to successfully completing all the required exams and fulfilling the necessary practical experience requirements.

Jaber said, ***"the ACCA qualification has equipped me with a comprehensive understanding of accounting principles, financial management, taxation, and various other areas of expertise. It has not only sharpened my analytical skills and strategic thinking but also enhanced my ethical awareness, positioning me as a competent and trusted finance professional."***

I owe a great deal of gratitude to the GRCL family and my own family for their unwavering support and encouragement throughout this journey. Their belief in my capabilities has been a constant source of motivation, and I am truly grateful for the opportunities they have provided me to grow and excel in my career. I am excited about the opportunities that lie ahead and look forward to making meaningful contributions in my field as an ACCA member."



SKYDIVE



ON SATURDAY, 13th July 2024 @ 14:00, Tony Nieli (GRCL Plant & Vehicle Coordinator) is participating in a SKYDIVE...

Tony is raising much needed funds for Herts Young Homeless (HYH) -

[Homeless Charity Hertfordshire | hyh](https://www.justgiving.com/page/tony-nieli-1715854489977)

If you would like to donate to this fantastic cause please follow the link below:

<https://www.justgiving.com/page/tony-nieli-1715854489977>

**GOOD LUCK TONY
AND
THANK YOU ALL FOR YOUR KIND DONATIONS**



Global
Rail
Services



Global Rail Services undertook the task of upgrading the electrical infrastructure at Killarney Train Station in County Kerry, which included removing old electrical services from the station's facade and installing new ones inside.

To ensure minimal disruption to daily operations, this process has been gradual, involving a thorough identification and testing of existing cables. Redundant cables were promptly removed. Additionally, new cable routes were established, necessitating the installation of new ducting, electrical chambers, and standalone distribution cabinets on the platform.

All civil work was performed manually to reduce impact on the station and public. These new routes not only eliminate unsightly cabling on the facade but also enhance electrical maintenance capabilities.



Global Rail Services has proven experience in delivering some of the most exciting projects across a diverse range of service sectors.

Our in-house capabilities, our scale and our supply chain partnerships have allowed Global Rail Services to deliver complex multi-disciplinary projects that make a positive difference to our clients, across the Irish infrastructure industry that we serve.

Kish Lighthouse

Lightning Protection Solution (LPS)

The Kish Lighthouse stands proudly on the Kish sandbank, situated approximately 11 kilometers off the Dublin coast in the Irish Sea. Originally erected in Dún Laoghaire Harbour back in 1965, it was later transported from the harbor and carefully positioned onto its current location.

Commissioned by the Commissioner of Irish Lights, **Global Rail Services** has been entrusted with the crucial task of upgrading the lighthouse's lightning protection system. This upgrade is designed to meet the latest standard outlined in BS EN 62305-3.

The primary objectives include safeguarding the structure against physical damage through the implementation of a new lightning protection system. Additionally, the system aims to mitigate the risk of injury to living beings from touch and step voltages within the vicinity of the lightning protection system (LPS).



Design Overview

As a key aspect of the project, we will be installing 10 Lightning Strike Pads around the circumference of the helipad, strategically positioned at 5-meter intervals. Each pad will be securely mounted onto the central steel rail of the netted section, anchored to an air rod base firmly attached to the structure. This critical addition is meticulously designed to bolster the lighthouse's lightning strike protection capabilities while minimising the risk of interference for incoming helicopters during landing operations.

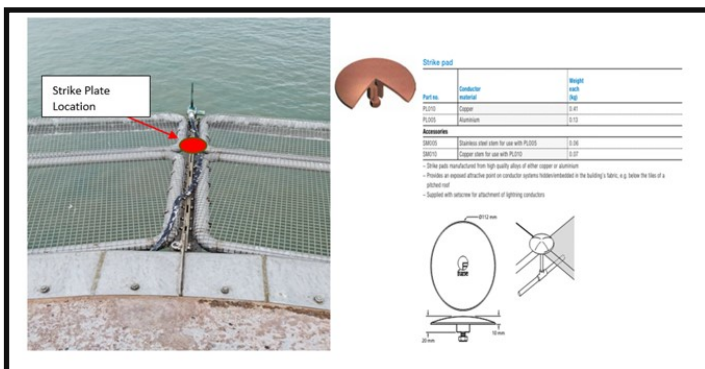

Conductors Route to Ground

The upgraded lightning conductors will be firmly affixed to the vertical section of the concrete structure, seamlessly connected to the newly installed coronal band encircling the exterior wall of the lamp room.

Descending vertically down the lighthouse's exterior wall, the new downconductors will extend below sea level. Here, they will be linked to 2 solid copper earth plates measuring 900mm x 900mm each, securely fastened to a sloped area of the structure submerged underwater. This intricate aspect of the project will be expertly executed by a specialised driving contractor.

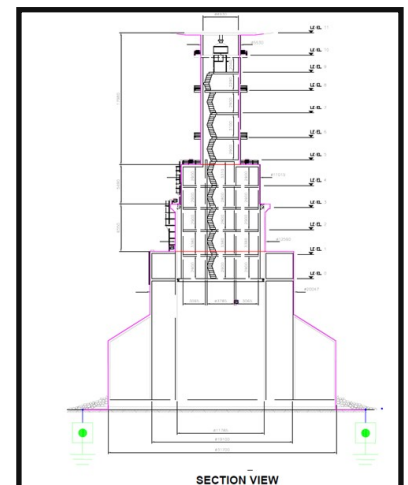



On April 26, 2024, Tommy Costello, our Storeman at **Global Rail Services**, made the heartfelt decision to retire from his position after nearly six years of dedicated service. On Tommy's final day, we came together to express our appreciation and bid him farewell with a heartfelt gift from all of us. Later in the evening, we gathered at the Osprey Hotel in Naas, Co. Kildare for a memorable dinner in his honor. Tommy was showered with gifts from both the company and his colleagues, a testament to the impact he has made during his time with us.

As Tommy embarks on this new chapter of his life, we extend our warmest wishes for a fulfilling and joyous retirement. He will be greatly missed, and his legacy within our team will continue to inspire us.



Tommy Costello (L) receiving his retirement gift from Stephen O'Brien (GRSL Director)



A DAY IN THE LIFE OF

In this issue, we meet Brian Cunningham - Electrician - for Global Rail Services

Why did you choose this profession?

I have always had an interest in how things work and love that aspect of electrical.

What are your most favourite things about the job?

Always learning everyday.

What excites you the most about the work?

Meeting new people and growing my knowledge.

What do you feel most proud of?

Successfully attaining my qualification and completing college.

Hobbies and special interests?

Fishing, gym, cars, Formula 1 and football.

What is your favourite sport?

Football.

How do you spend your free time?

Mostly fishing and gym.

What is your favourite music?

Country music is my favourite but I do love all types overall.

What was one of your most defining moments in life?

Successfully completing my apprenticeship and getting qualified.

What is your strongest quality?

I would say I have great patience whilst staying calm in stressful situations.

What does a typical day look like for you?

It changes so much each day but normally wiring or installing something electrical.

What is the most fun part of your daily routine?

Getting that first morning coffee.

What was your most embarrassing moment?

The time I got knocked out running into an ESB pole, in front of everyone, on a night out.



THANK YOU BRIAN, FOR YOUR TIME



Martin Brophy
Electrical Contract Supervisor



Marius Postolachi
ESB Supervisor



Paul Woods Contracts Manager
(Building & Facilities)



Stelion Poiana
General Operative (Civils)



Phil Woods
Electrical Contracts Supervisor



Stewart McMickan
Electrical Contracts Supervisor



Sean Joyce
Supervisor Chargehand

CONGRATULATIONS & THANK YOU

On a personal note, Marco Lombardelli (GRCL MD) & Ivan Holloway (GRA CEO) conveyed the following message -
"We extend our heartfelt gratitude to each and every one of you for your unwavering loyalty, dedication, and tireless efforts over the past decade. We eagerly anticipate continuing our collaboration for another ten years."



Stefan Aspataritei
General Operative (Civils)

CONGRATULATIONS

Robert Doboos
(GRCL Supervisor)
10 Years Service

**CONGRATULATIONS**

Bhupinder Singh
(GRCL Operative)
10 Years Service



Vas Vancea (GRCL Project Manager (L))
presenting Robert Doboos with his award



Barry Smith (GRCL Project Manager (R))
presenting Bhupinder Singh with his award

Global Rail Construction Ltd (GRCL)

were delighted to celebrate the **10 Year Anniversary** of GRCL Supervisor **Robert Doboos**.

Robert has provided his services to GRCL over the course of the last 10 years and is able to assist with complex and challenging contracts. His guidance and support has been instrumental in enhancing the effectiveness of our teams.

Global Rail Construction Ltd (GRCL)

were thrilled to commemorate the **10 Year Anniversary** of GRCL Operative, **Bhupinder Singh**.

Bhupinder, a dedicated GRCL Operative, has contributed his expertise to GRCL for the past decade, offering valuable assistance in navigating complex and challenging works.

We would like to take this opportunity to thank Robert and Bhupinder for their continued professionalism and commitment whilst engaged with ourselves and look forward to working together on future projects



We are always supporting Mental Health, but especially during Mental Health Awareness Week 2024, which took place between the 13th to 19th May 2024, with a theme of

“Movement: Moving more for our mental health.”

Mental health is an integral part of our overall well-being. Yet, despite its importance, there's still a significant amount of misunderstanding and stigma surrounding mental health conditions. Mental Health Awareness Week aims to educate the public, normalise conversations about mental health, and show that it's okay not to be okay.

Research has shown that regular physical activity can make us happier and healthier. Our bodies release feel-good hormones when we're active, which can reduce anxiety and stress and help us sleep better. By building movement into our working day, we can have a positive impact on productivity and focus.

Movement is so important for our mental health, however, so many of us struggle to move enough. There are many different reasons for this, so this Mental Health Awareness Week it's about helping, supporting and encouraging people to find moments for movement in their daily routines.

When life's busy, it can be tricky finding time for wellbeing-boosting activities. But finding moments for movement might be easier than you think and these moments will of course add up. This could be going for a walk in your neighbourhood, putting on your favourite music and dancing around the living room, chair exercises when you're watching television – anything goes!

Get more tips from the Mental Health Foundation: <https://www.mentalhealth.org.uk/>

**Find moments for
movement every day**

Why not use the time you spend
waiting to move? Like when the
kettle's boiling!



**MENTAL
HEALTH
AWARENESS
WEEK**
13-19 MAY 2024





Workers' Memorial Day, also known as International Workers' Memorial Day or International Commemoration Day for Dead and Injured is celebrated on the 28th April. This takes place around the world, as an international day of remembrance and action for workers killed, disabled, injured, or made unwell by their work.

April 28 is the anniversary of the date the Occupational Safety and Health Act of 1970 went into effect, and when the Occupational Safety and Health Administration was formed

(April 28, 1971). There is still much work to do to raise safety standards and there are still industry cases where worker safety is compromised.

Worker safety is not optional. Nobody should ever be put at risk of death or injury to hit deadlines or budgeting considerations.

Workers' Memorial Day is an opportunity to highlight the preventable nature of most workplace incidents and ill health and to promote campaigns for improvements in workplace safety.

The slogan for the day is **Remember the dead – Fight for the living.**

The RSK Group of companies are committed to complying with legislation to ensure the highest standards of safety are achieved and maintained. Health and well-being is central to our approach, and continuous improvement in occupational health and safety management and performance is achieved through the implementation and maintenance of occupational health and safety management systems.

Our safety management ethos is based on risk assessment and control throughout our operations. We constantly endeavour to provide a safe place of work, with safe and maintained plant, equipment, and systems of work.

This approach is enhanced through the provision of appropriate information, instruction, and training on and off site, ensuring safe use of materials and substances and by diligently working to prevent accidents.

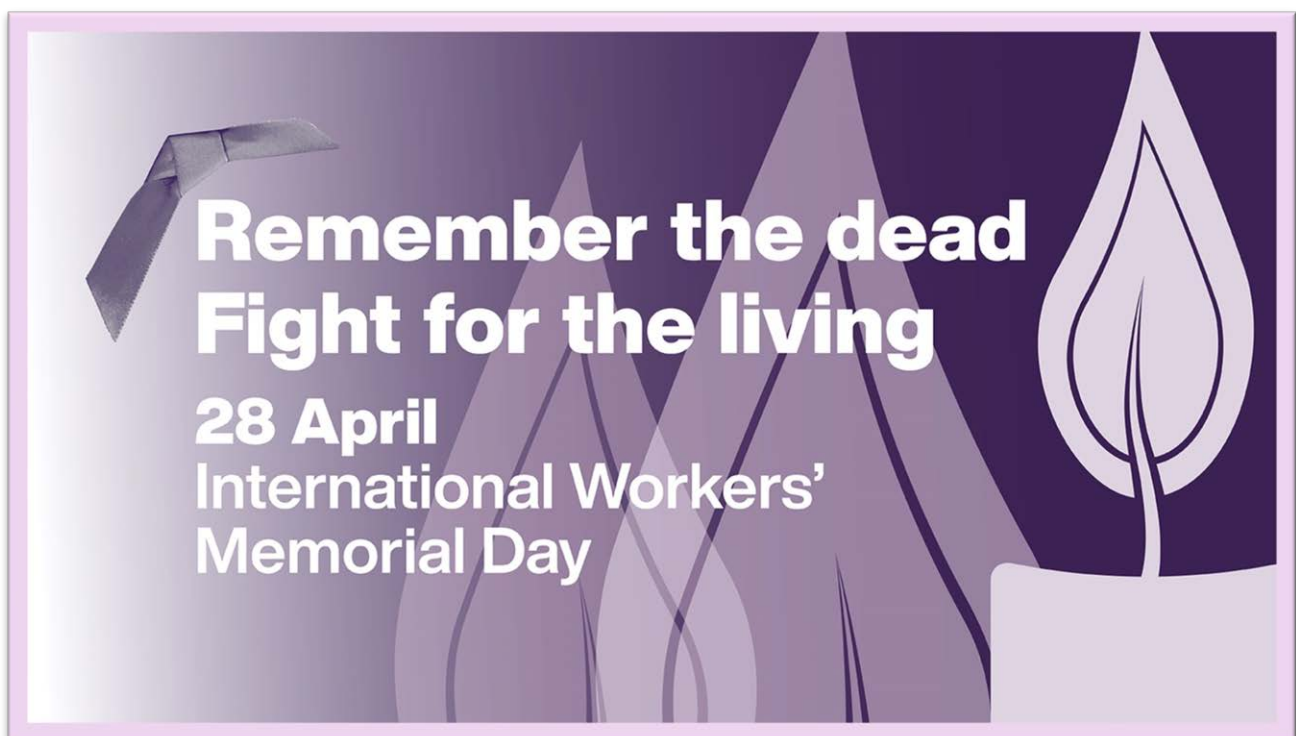

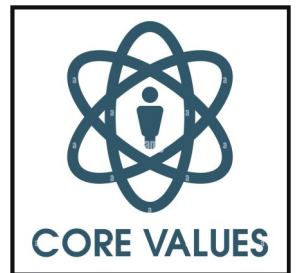

Global Rail Construction Limited, is proud to announce a collaboration with Adeyfield Free Church. This is to support their incredible initiative, Playskill, which, is a free nursery programme for pre-school-aged children with physical delays and disabilities, providing vital support to parents in Hemel Hempstead. Following discussions with the local council, the Church decided to submit a planning application to create an outdoor play space and equipment storage area. In its commitment to giving back to the local community, **Global Rail Construction's design team** stepped in to offer their services, free of charge, to produce the necessary drawings for the planning application. Ian Foster, Senior Design Engineer, expressed his delight in using his experience to support such a worthwhile cause:

"It's an honour to contribute to this project, reflecting one of our company's core values of 'Responsibility' - supporting communities and protecting the environments that we work in. Together, we're laying the groundwork for Playskill's future outdoor play facilities."

Learn more about Playskill and their incredible work here: <https://www.playskill.org/>

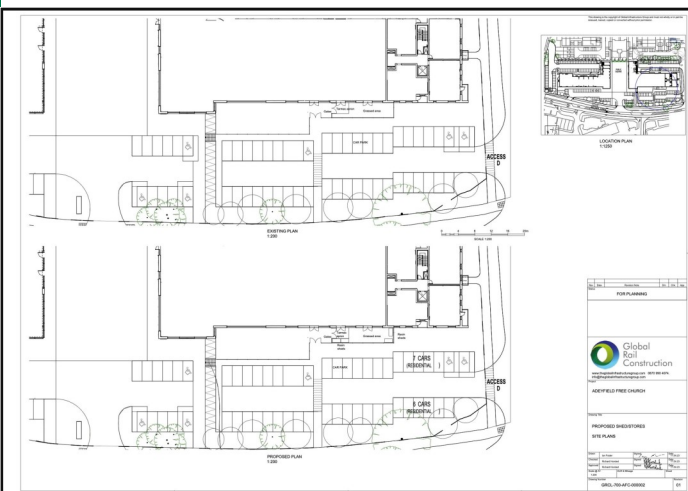



Global Rail Construction's (GRCL) Commercial Manager, Emma Russell, (pictured third from the left) has volunteered to be a mentor for Women in Rail. We would like to express our thanks to Emma for dedicating her time to this not for profit organisation, in order to provide support and ideas for women and men in UK rail and to champion and promote diverse thinking.

Formed in 2001 as supplier to the UK rail industry, Global Rail Construction Limited is a household name for design and implementation of rail schemes on both mainline and metro rail infrastructure.

Forming part the Global Infrastructure Group brand, we have operations spanning both the UK and Ireland, and have several hundred directly employed staff as part of our multi-disciplinary delivery teams.

We employ individuals who understand the requirements of delivering rail objectives safely, on time and to budget and are fully focused on ensuring that our reputation within the industry and client relationships are maintained.

We have spent time developing our own direct workforce to ensure they are aware and support a diverse culture.

This approach has enabled our businesses to develop into a long-term sustainable employers and it is this constancy that has allowed us to grow and be able to support these fantastic causes.





Global Rail Construction Limited (GRCL), recently supported a local Scout Group in Welwyn Garden City, by supplying them with work gloves to aid site clearance works and maintenance of their 'Scout Hut' - which is nearly a century old! Operating as a charity and run by volunteers, every ounce of help is invaluable to this local cause.

Nicola Arnett, GRCL's Competency and Resource Coordinator and a parent of one of the scouts, also volunteered for the task and added:

"It was quite a messy job with plenty to clear, including old fencing, bricks, rubbish, and a plethora of brambles. The gloves proved immensely helpful in safeguarding our hands".



On April 16, 2024, GRCL conducted a safety stand-down session at our Cambridge site. The purpose of the session was to reinforce the project requirements and team members' responsibilities. Additionally, some members of the GRCL Senior Leadership Team attended.

The session provided an opportunity to address project issues and recent challenges, resulting in a highly successful engagement.

**THANK YOU
TO ALL WHO ATTENDED**





Supporting Vulnerable People in Hertfordshire



Global Rail Construction Limited part of the RSK Group team thoroughly enjoyed their Charity Golf Day at Stocks Golf Club as a headline sponsor, raising important funds for its charity partner **Herts Young Homeless**.

We are delighted to say that with our support, the day raised the huge sum of **£7,989** - making a big difference to the lives of young people in Hertfordshire who are facing homelessness.

This equates to:

- * 20 calls answered to our Advice Line to give advice and support to a young person in crisis.
- * Food and essentials for 20 young people for one week.
- * 15 counselling sessions for young people to support with their mental health.
- * 10 Mediation sessions for a young person and their family to help prevent family breakdown, the leading cause of youth homelessness in Hertfordshire.
- * Two-hour Outreach sessions for 12 young people which could include helping to find suitable accommodation, independent living skills, general tenancy sustainment or income/budgeting advice.
- * Deposit and rent in advance for 4 young people.

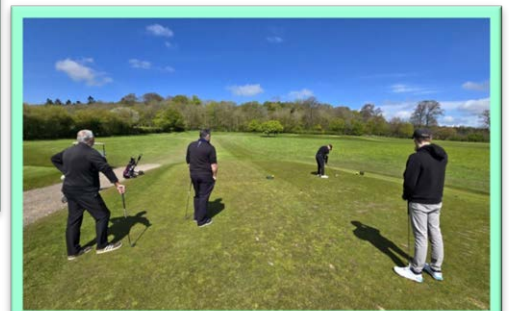



Supporting Vulnerable People in Hertfordshire



Global Rail Construction Ltd (GRCL)

Senior Design Manager Richard Horsted successfully completed the London Half Marathon on Sunday, 07th April 2024 - running in partnership with GRCL's chosen charity partner Herts Young Homeless. Richard had a knee injury in the build-up, but thankfully, with careful management, he managed to get around - what a fantastic achievement supporting such a great cause. Richard added himself:

"I'm not too sure my knee is thanking me now, but it did hold out! It was a really great day and I would recommend it to anyone wanting to complete a half marathon. The crowds were amazing as were all the bands, they really helped along the way. Thanks for giving me the opportunity to take part in such a great event. For the time being I'm going to concentrate on getting my knee better, but I think I'm going to redo the event next year so I can run it injury free."



In a heartwarming display of support, the **Global Rail Construction** family recently had the privilege of donating Easter Eggs to the charity we proudly support, Herts Young Homeless (HYH). It's moments like these that remind us of the importance of giving back to our community and making a positive impact in the lives of those in need.

Our team were grateful for the opportunity to spread some Easter cheer and look forward to continuing their support for such a worthy charity.



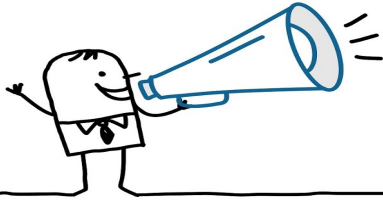

Welcome To The Global Family...



Nisad Jakupovic
Senior CAD Technician



Phillip Churchill
Material & Plant Coordinator

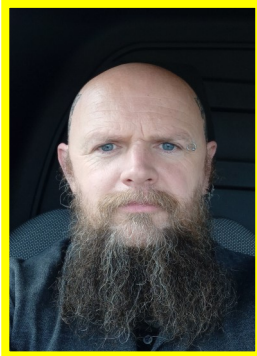

Mel Ging
Storeman



Anita Zgagacz
Accounts Assistant



HAPPY BIRTHDAY

A very Happy **50th** Birthday to Para Pratheeb
(GRCL Finance Manager)
who celebrated his birthday in May.



We all hope you had a wonderful time celebrating this milestone birthday



HAPPY BIRTHDAY

A very Happy **40th** Birthday to Daljit Dhesi
(GRCL Commercial Assistant)
who celebrated her birthday in April.



We all hope you had a wonderful time celebrating this milestone birthday



Part of the RSK Group of companies

A Leading Provider Of Turnkey Solutions For The Rail Industry



Railway
Construction



Civil
Engineering



Telecomms



Multi-Utilities



Power
Networks



General
Construction



Design and
Consultancy

Combining technical and innovative excellence with a
real passion for detail and safe delivery of projects

www.theglobalinfrastructuregroup.com